

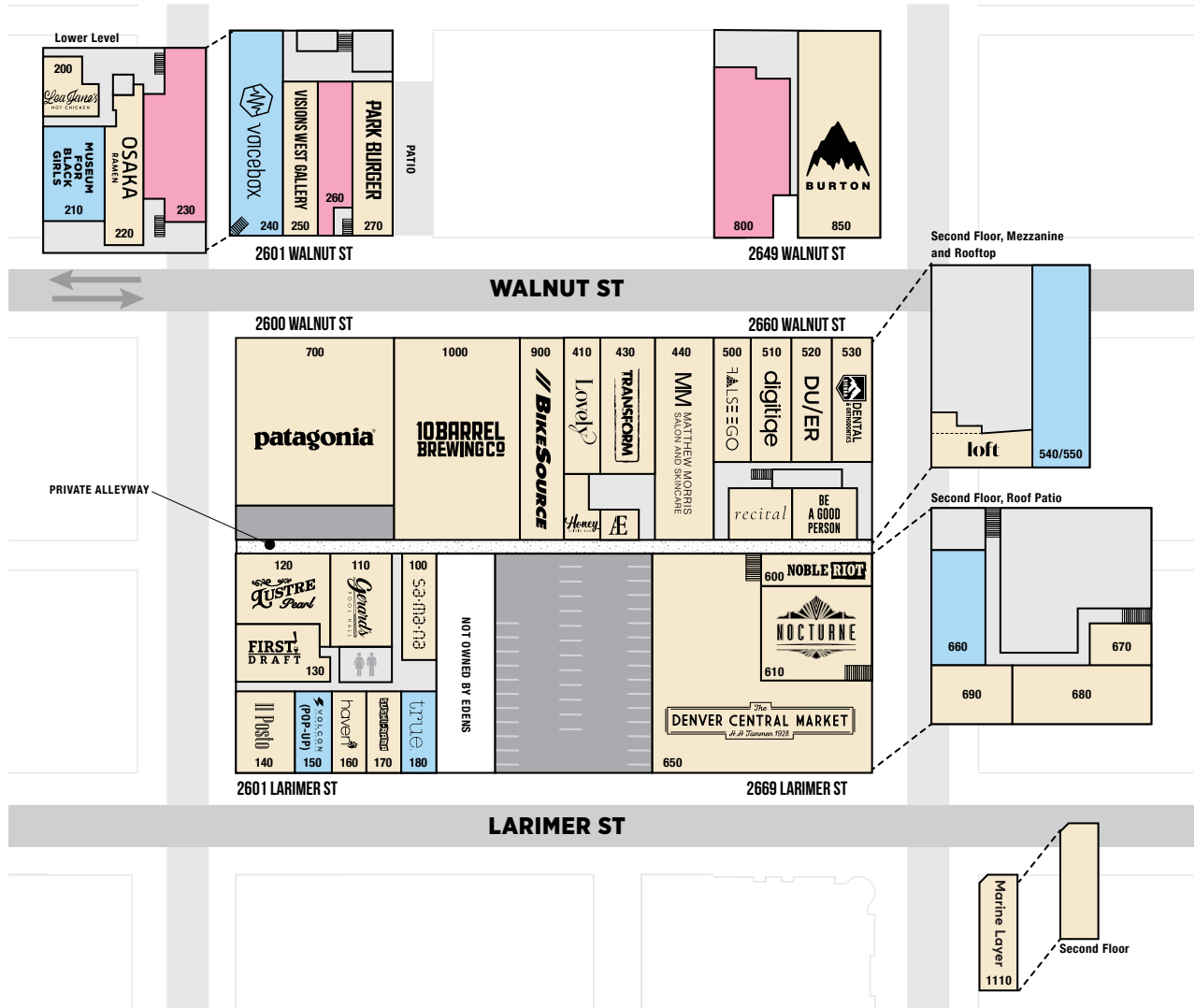

# EXISTING SITE PLAN

NO.	RETAILER NAME	SF
100	Samana Float Center	1,626
110	Gerard's Pool Hall	2,886
120	Lustre Pearl Denver	3,443
130	First Draft	2,521
140	Il Posto	3,502
150	Volcon (Pop-up)	1,394
160	Haven	1,410
170	Sushi-Rama	1,407
180	True Boutique	1,402
200	Lea Janes Hot Chicken	1,264
210	Museum for Black Girls (Pop-up)	3,684
220	Osaka Ramen	2,487
230	Available	4,129
240	Voicebox	5,659
250	Visions West Gallery	2,130
260	Available	2,024
270	Park Burger	2,798
400	AE (Pop-up)	491
410	Lovely Bride Denver	2,391
420	Honey Elixer Bar	1,126
430	Transform Colorado	3,492
440	Matthew Morris Salon	5,000
500	False Ego	1,838
510	Digitiqe	1,781
520	DUER	1,824
530	Sierra Dental & Orthodontics	1,791
540	Madison & Company (Office)	2,603
550	Downtown Prop. Serv. (Office)	2,442
560	Be A Good Person	1,415
570	Recital	1,416
600	Noble Riot	1,657
610	Nocturne	3,654
650	Denver Central Market	11,946
660	Agentsync (Office)	1,250
670	The Bodywork Guru	349
680	Madwell	3,135



NO.	RETAILER NAME	SF
690	Sidecar Public Relations	2,904
700	Patagonia	10,443
850	Burton	6,000
800	Available	5,487
900	BikeSource	3,118
1000	10 Barrel Brewing Co.	9,400
1110	Marine Layer	4,625

# PHOTOS

## RINO HIGHLIGHTS

- Situated in the booming RiNo Arts and Retail District.
- The neighborhood has seamless access to downtown — a 5-minute bike ride or 10-minute walk.
- Tremendous buying power of \$11B within 3 miles.
- Densely populated, over 37,172 people live within 1 mile.



## WHERE ART IS MADE:

**22**      **190**

Galleries      Studios

**430**      **140**

Artists      Makers

**168**

Creative  
Businesses



# TRADE AREA



	1 Mile	3 Miles	5 Miles
<b>Total Population</b>	39,143	220,317	463,631
<b>Avg. Household Income</b>	\$113,618	\$102,128	\$104,117
<b>Buying Power</b>	\$2.5B	\$11.5B	\$22.2B
<b>Educational Attainment</b>	63.7%	59.9%	51.8%
<b>Daytime Population</b>	64,812	320,657	581,759
<b>Median Age</b>	34.3	34.57	35.6